



**SOLID STEERING COLUMN BUSHING
INSTALLATION INSTRUCTIONS:**

89-94 NISSAN 180SX/240SX/SILVIA S13

90-96 NISSAN 300ZX/FAIRLADY Z32

89-94 NISSAN SKYLINE GTR, GTS, & GTST R32

PART NUMBERS:

V00-CBNS-0100

We recommend that installation of all Voodoo13 parts be completed by a professional who is experienced in suspension tuning. With proper installation and maintenance, Voodoo13 suspension products will provide exceptional performance and durability. For any questions, please contact Voodoo 13 immediately. We thank you for choosing Voodoo13 for your suspension tuning needs!

NEED HELP?

Our representatives are here to help you with any questions concerning the operation of this product.

CALL 480-889-0812

Monday thru Friday 8:30am to 5:30pm MST

RECOMMENDED TOOLS AND SUPPLIES

- General Mechanics Tool Set
- 10mm and 12mm Socket
- Ratchet
- Philips Screwdriver

PART BREAKDOWN

NOTE: For any OE hardware please refer to OEM service manual for torque specifications. For all included hardware please torque to specifications shown below.

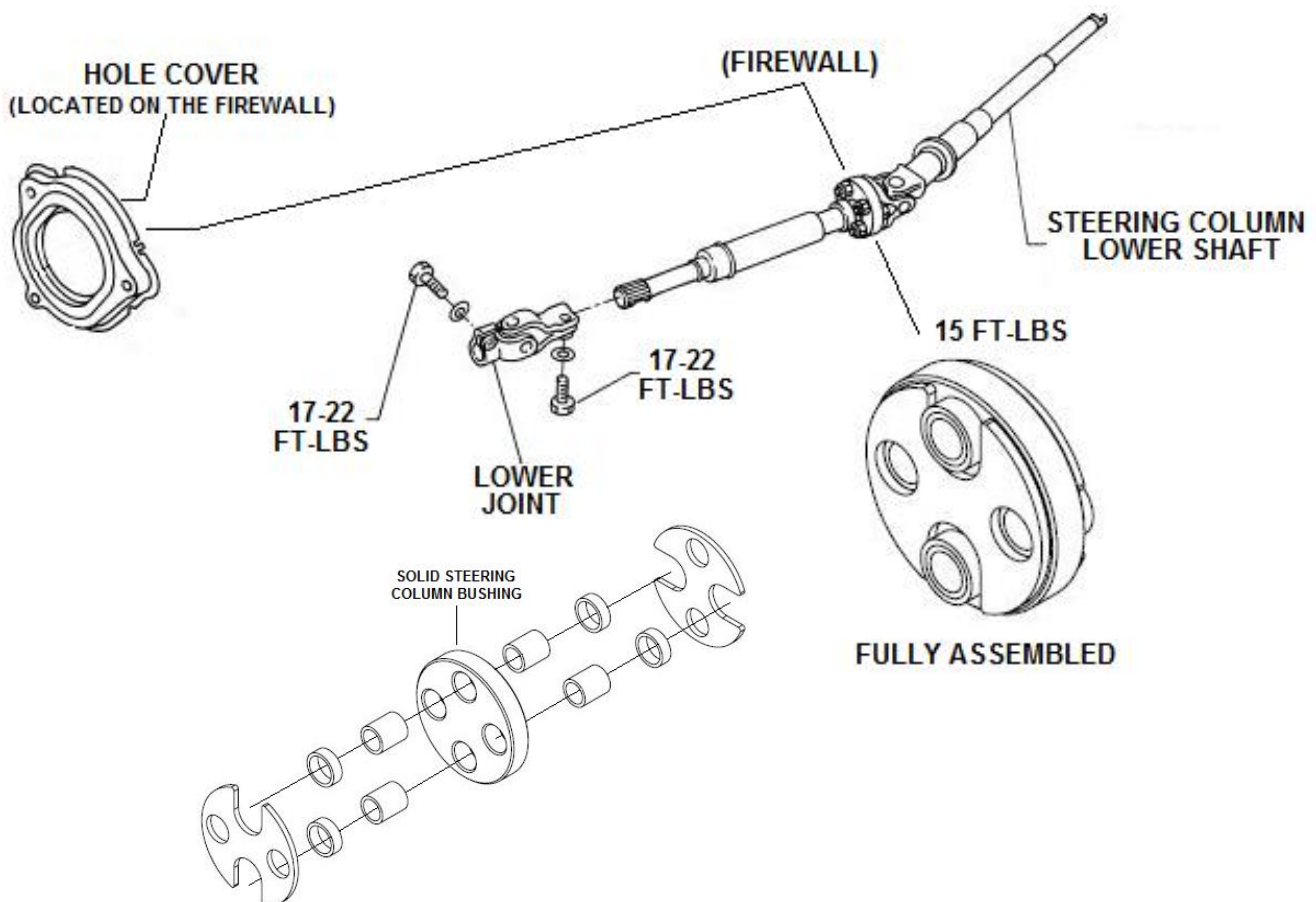

INSTALLATION PROCEDURES

Option 1: Without Engine

Option 2: Engine Intact

Option 1:

Step 1: Lift the front of the vehicle to a safe height using the recommended factory lift points in order to be able to rotate the steering shaft assembly. This will make accessing the bolts easier.

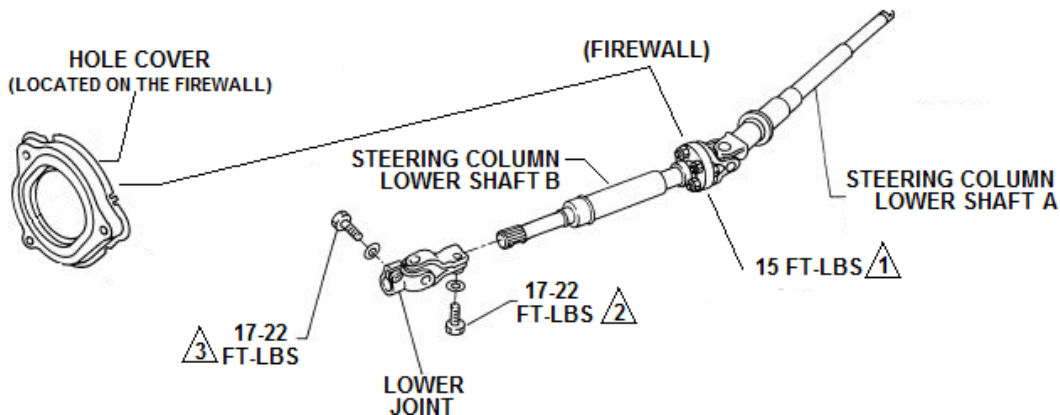

Step 2: Pop the hood to locate the *STEERING COLUMN LOWER SHAFT B*. Once you find the *HOLE COVER* you can begin the removal process. (The hole cover may be located on the left or right side of the firewall depending on LHD or RHD models). On the diagram, *triangle 1*, there are two 12mm nuts that need to be removed.

Step 3: Next move on to the *LOWER JOINT*, remove the bolts labeled 2 and 3. The *LOWER JOINT* is connected to the steering rack. Once removed, the *STEERING COLUMN LOWER SHAFT B* can be slipped/wiggled out.

Step 4: To finally remove the bushing, there are two more 12mm nuts holding it together. Once removed, disassemble the bushing like the diagram shown below and reassemble with the new solid bushing. Then reinstall in reverse order. Torque nuts #1 to 15 ft-lbs, and 17-22 ft-lbs for bolts #2 and #3.

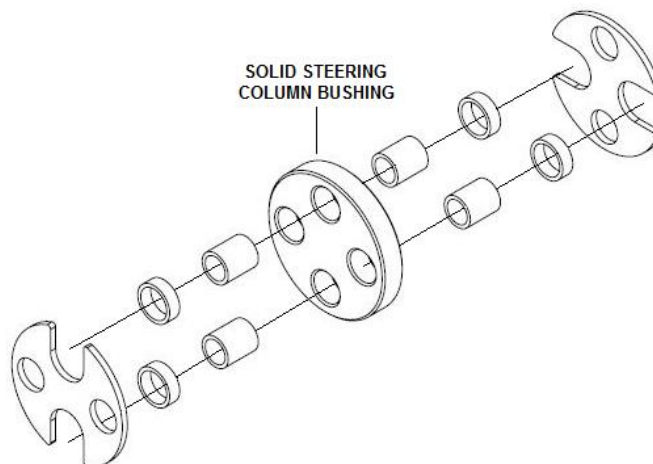

Option 2:

Step 1: Locate the panel underneath the steering column inside the interior. Under the steering wheel there's a panel held with several 10mm bolts. Remove these first, however leave the panel intact. Locate a bolt removable by a philps screwdriver. Should be further back at the end of the panel adjacent to the center console. Now slide the panel towards the rear of the car.

Step 2: Remove the bolt labeled as #2 from the lower joint connecting the rack and the steering shaft. Use the diagram below.

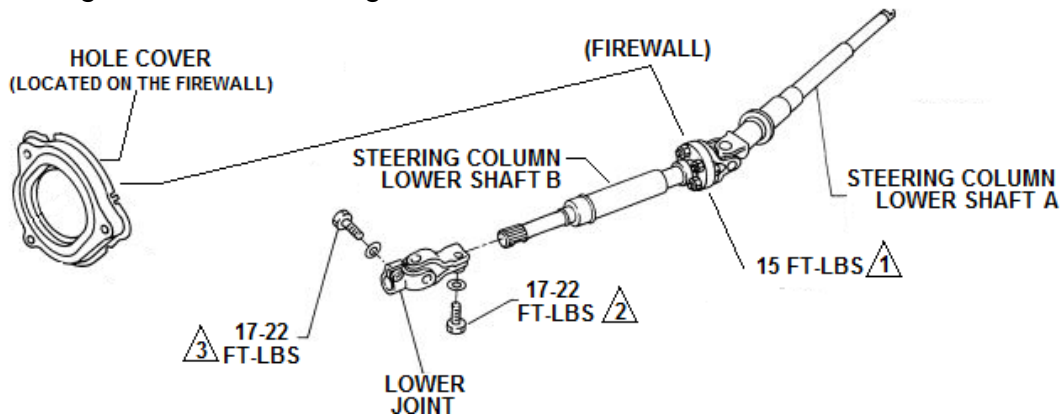

Step 3: Use the next diagram below for the next step in instructions. Next locate bolts #1 thru #7 that are securing the steering column. Remove #5, #6, and #7 first which are located against the firewall. Bolts #1 thru #4 can now be removed.

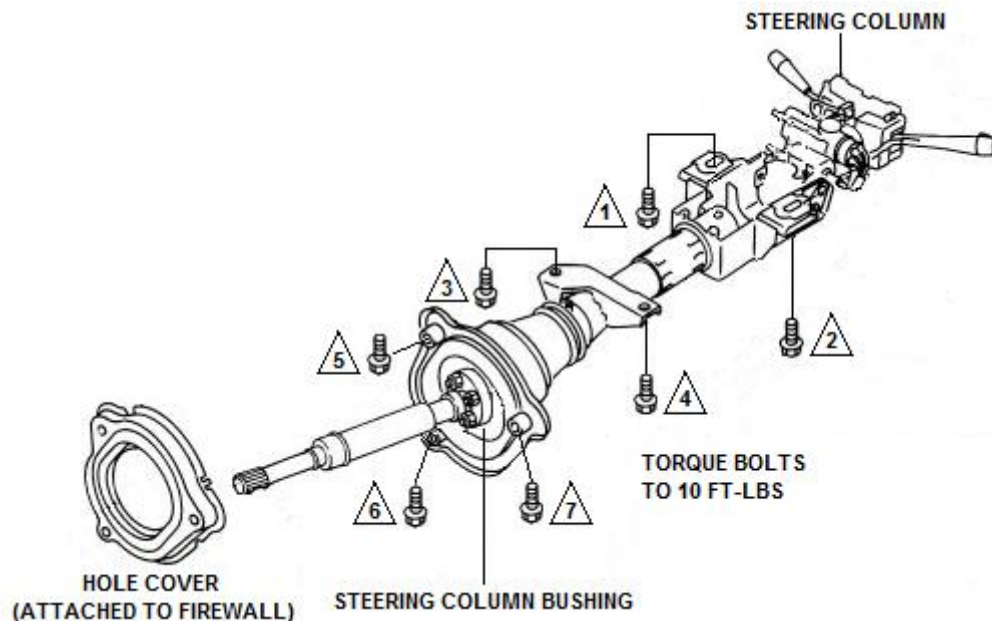

Step 4: Now you should be able to pull and slide out the *STEERING COLUMN LOWER SHAFT B* from the lower joint. From there remove the two 12mm nuts on the *STEERING COLUMN BUSHING*. Then the shaft can be pulled apart from the rest of the steering column with the bushing still attached.

Step 5: To finally remove the bushing, there are two more 12mm nuts holding it together. Once removed, disassemble the bushing like the diagram shown below and reassemble with the new solid bushing. Reinstall shaft with the new bushing back to the steering column. Then torque the two 12mm nuts from before to 15 ft-lbs.

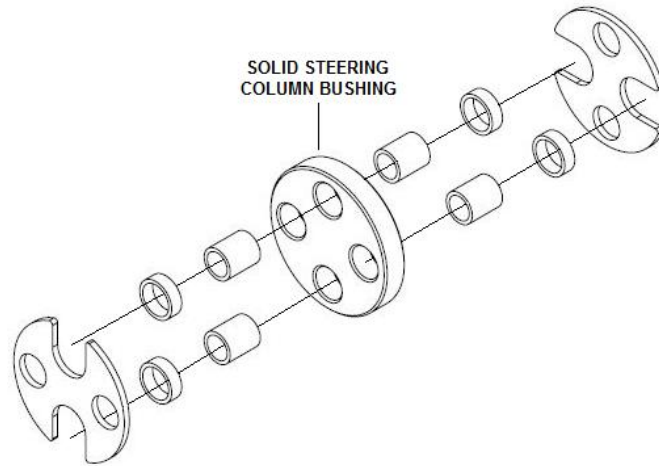

Step 6: To reinstall the *STEERING COLUMN*, may need another person for assistance in reinstalling the *STEERING COLUMN LOWER SHAFT B* back into the lower joint. Do not torque down bolt #2 yet until finishing up the rest of the install.

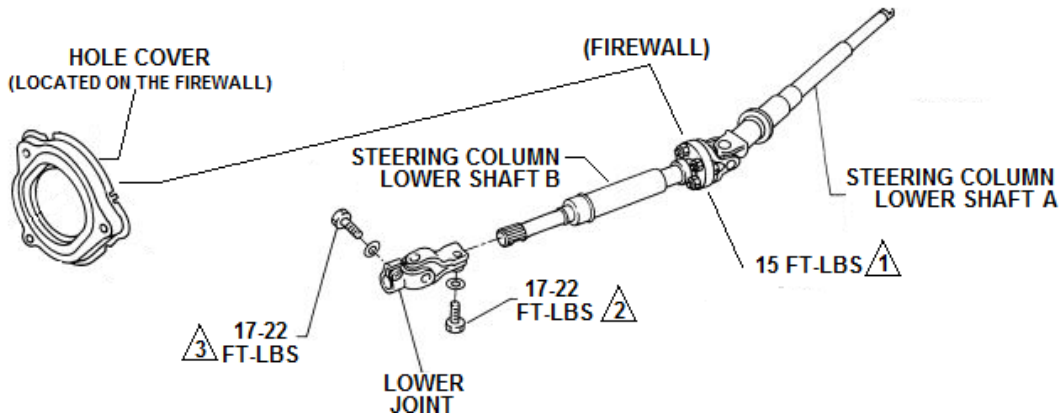

Step 7: After the shaft is back in the *LOWER JOINT*, reinstall bolts #1 thru #4 to secure the *STEERING COLUMN* back in its place. Torque bolts to 10 ft-lbs.

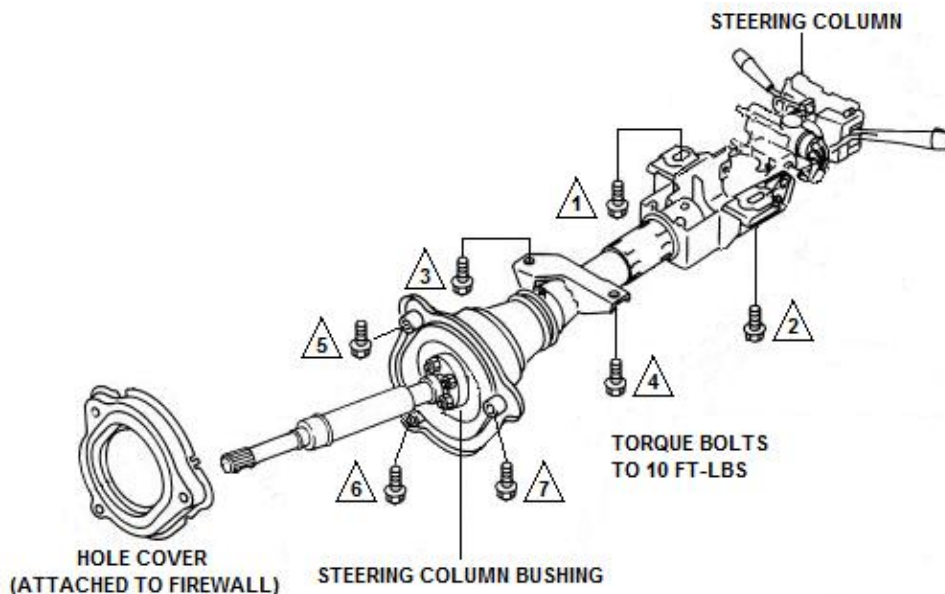

Step 8: To finish the installation of the *STEERING COLUMN*, reinstall #5 thru #7 bolts and torque to 10 ft-lbs. Use diagram from the last page.

Step 9: Now torque bolt #2 to 17-22 ft-lbs. Use the diagram below.

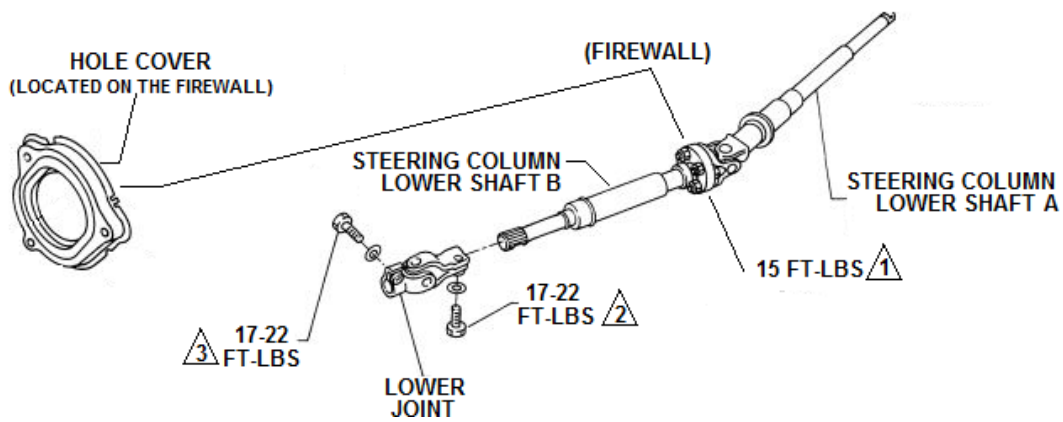

Step 10: Last step is to reinstall the panel with the bolts from before underneath the *STEERING COLUMN* and you are done.

WARRANTY

All products sold are subject to the following warranty:

Voodoo13 offers a Limited Lifetime Warranty for our products to the original retail consumer against defects and workmanship when used on light truck and car applications under normal operating conditions. This warranty does not apply to parts that have been improperly installed or wearable items such as, but not limited to, worn bushings or bearings unless proven to be defective from the manufacturer.

Exterior finish on all Voodoo13 products is not considered a valid warranty; consumers are responsible for the maintenance of paint, anodize or raw metal finish.

The consumer will be responsible for the removal and freight costs both to and from the Distributor from which the product was originally purchased. Proof of purchase and product registration through the Voodoo13 website is mandatory in order to receive warrantee replacement; original invoice from the Distributor from which the product was purchased must accompany the product in question for warrantee.

Voodoo13 has the right to refuse a warrantee claim if procedures are not met by the original consumer. All returns must have an R.M.A. approval from Voodoo13 prior to shipping direct to the Voodoo13 facility. Exclusions from this warranty are sales outside of the United States, the finish, dents, rust, or any condition caused by abnormal use or neglect.

WARNING

High performance parts. For off-road use only. Installation should be carried out by a qualified facility. Improper use or installation may result in injury or death.



VOODOO13
115 N Sunway Drive
Gilbert, AZ 85233
Ph: 480.889.0812
Fax: 480.829.8103
www.VOODOO13USA.com